

# *SawStop*<sup>®</sup>

## **30" OUT-FEED TABLE**

### **INSTALLATION INSTRUCTIONS**

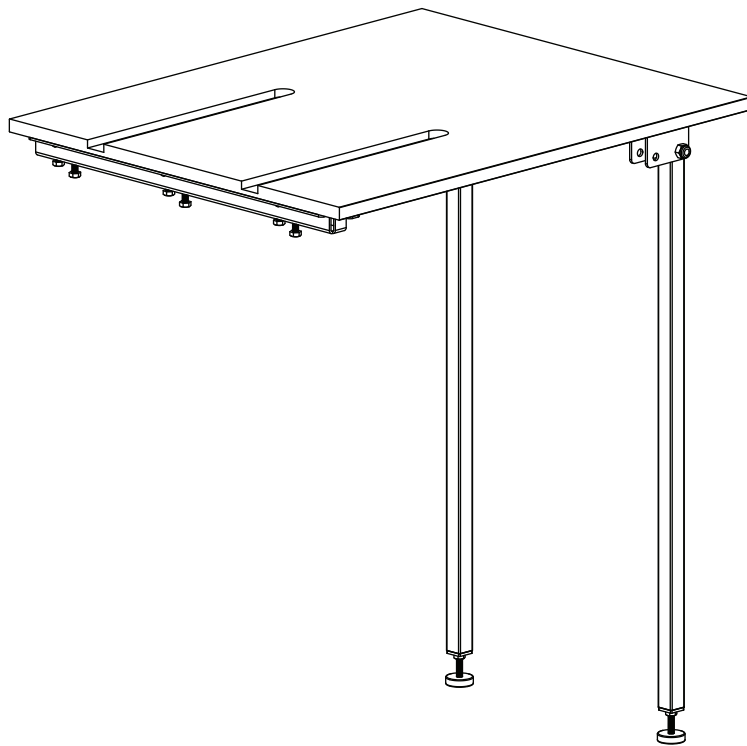

SawStop, LLC  
9564 S.W. Tualatin Road  
Tualatin, Oregon 97062  
[www.sawstop.com](http://www.sawstop.com)

Main Phone - (503) 570-3200  
Service - (503) 682-6222  
Fax - (503) 570-3303  
Email: [info@sawstop.com](mailto:info@sawstop.com)

# Installing Your Out-Feed Table

**Note:** The SawStop® Out-Feed Table is designed for use with the T-Glide™ Fence System - Professional Series. It does not attach to the SawStop® Contractor Fence Assembly.

1. The out-feed table comes pre-assembled and ready to install. Begin the installation by removing the two lower M10 nylon hex nuts and the corresponding M10 x 45 hex head bolts from the angle brackets on the bottom of the table (see Fig. 1). These bolts will be used in the next step to secure the support legs to the angle brackets.

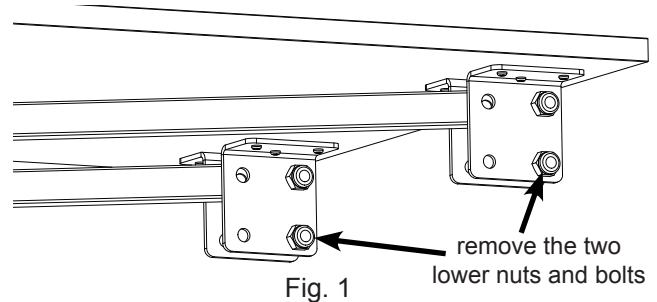

2. Rotate each support leg down until the hole in each leg aligns with the holes in the corresponding angle brackets, as shown in Fig. 2. Insert one of the M10 x 45 hex head bolts through the holes and thread one M10 nylon hex nut on each bolt. Tighten the two nuts you just installed as well as the already-installed nuts on the two upper bolts using two 17 mm wrenches.

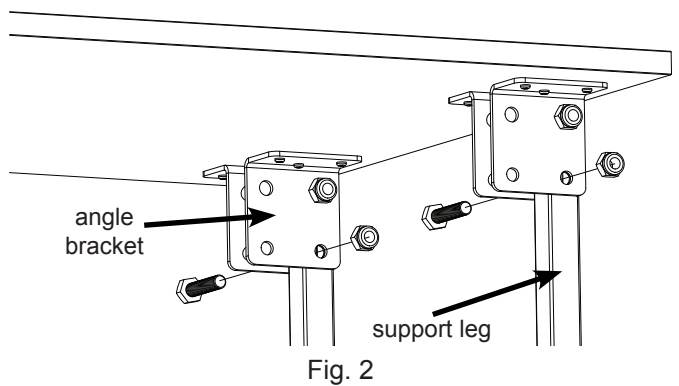

3. A mounting bracket is attached to the bottom of the out-feed table along the edge opposite the legs, and six M8 x 30 screws are in the mounting bracket. Three of these screws are mounting screws used to attach the out-feed table to the rear rail of the saw and the other three screws are adjustment screws used to level the out-feed table to the saw. Remove the three mounting screws shown in Fig. 3, being careful to remove the correct screws. If you remove the wrong screws, the miter slots in the out-feed table will not align with the miter slots in the saw table. Also, loosen the three adjustment screws several turns.

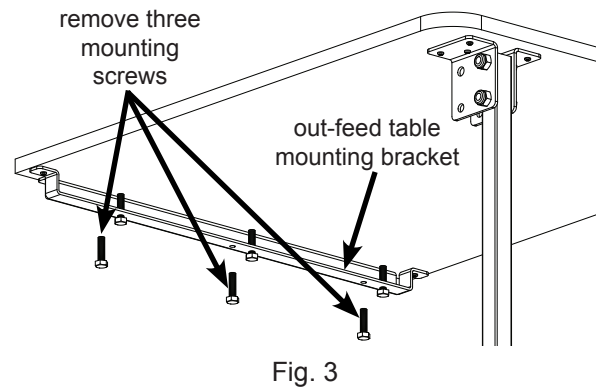

4. Set the out-feed table mounting bracket on the top surface of the rear rail so that the two miter slots in the top of the out-feed table align with the miter slots in the saw table (see Fig. 4).

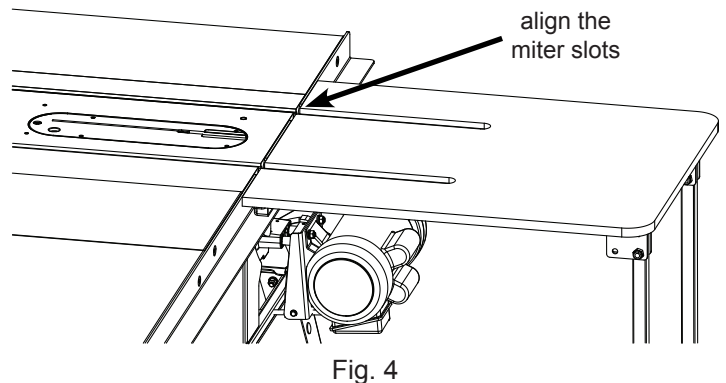

# Installing Your Out-Feed Table

5. Align the three holes in the rear rail with the three holes in the out-feed table mounting bracket and thread the three mounting screws through the rear rail and into the mounting bracket (see Fig. 5). Thread the screws into the mounting bracket enough so they engage the bracket, but do not tighten them. They need to remain loose so you can align the out-feed table to the saw.

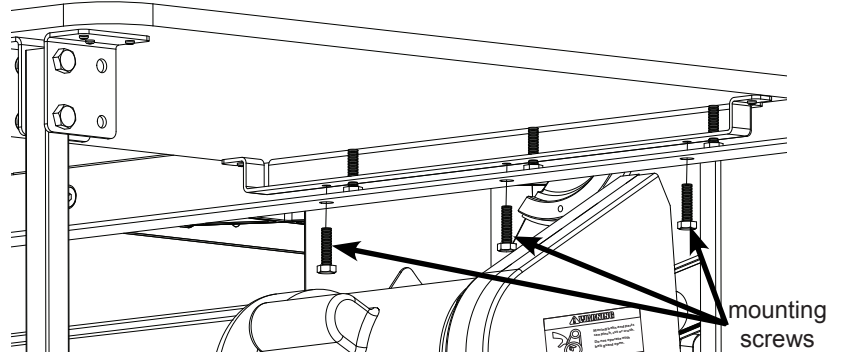

Fig. 5

6. Align the out-feed table to the saw table by turning the adjustment screws in the mounting bracket. The heads of the adjustment screws will contact the top surface of the rear rail when the out-feed table is in place on the saw, so turning the adjustment screws will raise or lower the out-feed table. Back the adjustment screws out of the mounting bracket to raise the out-feed table, and thread the adjustment screws into the mounting bracket to lower the out-feed table. Use a 13 mm wrench to set the height of each of the adjustment screws. Use a straight-edge to align the top surface of the out-feed table to the top surface of the saw. Once the top surfaces are aligned, tighten the three mounting screws using a 13 mm wrench. As you tighten the mounting screws you may need to further adjust the position of the adjustment screws to keep the top surfaces aligned.

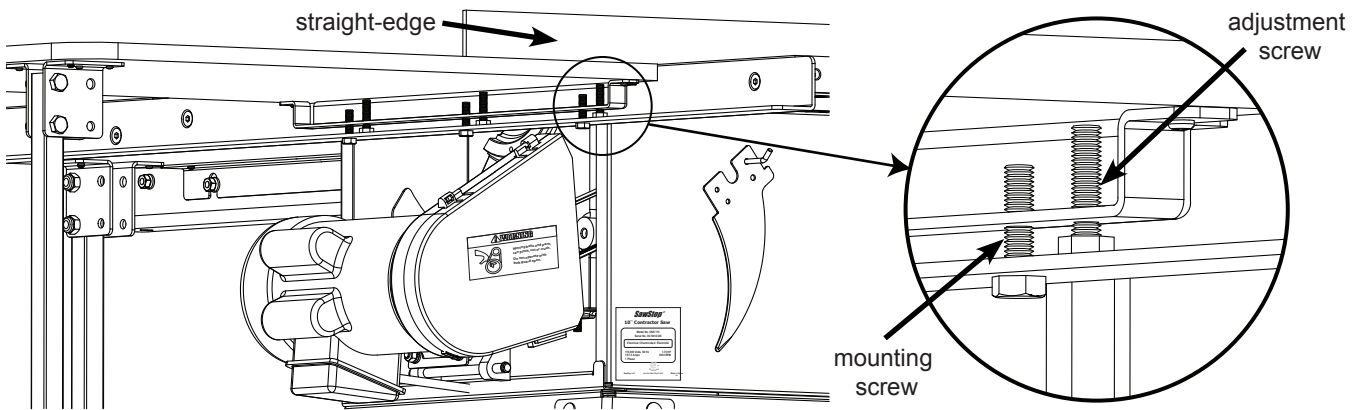

Fig. 6

7. Level the out-feed table by turning the foot on the bottom of each support leg until the top surface of the out-feed table is level with the top surface of the saw (see Fig. 7). Once the top surfaces are level, fully tighten the hex nut against the bottom of the legs using a 13 mm wrench (see Fig. 8).

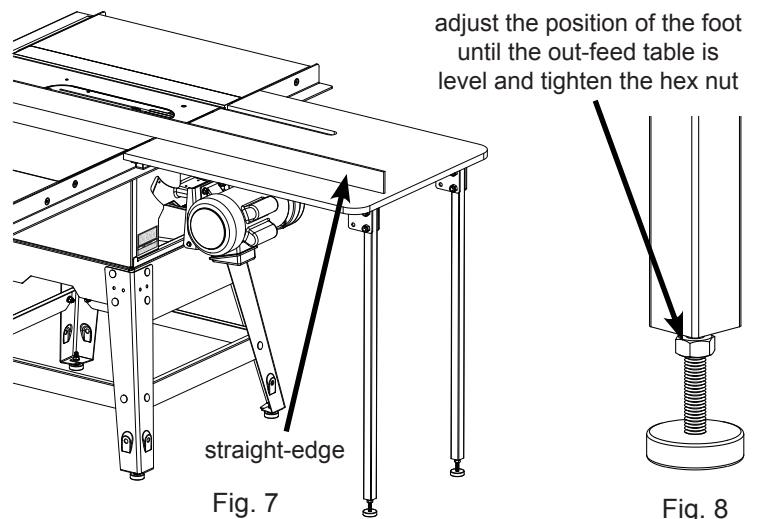
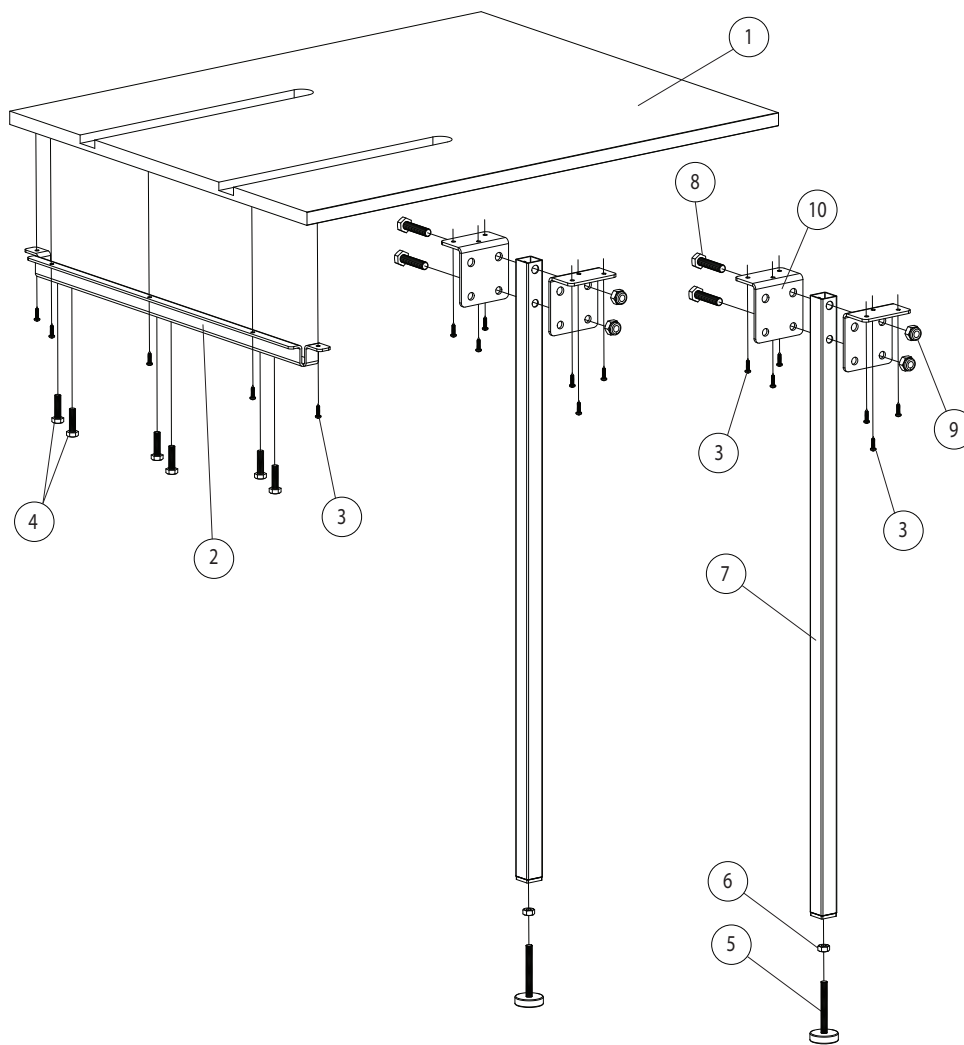

Fig. 7

Fig. 8

**Congratulations,  
your out-feed table is now  
installed and ready for use.**

# **30" Out-Feed Table Assembly Exploded View**



## **30" Out-Feed Table Assembly Parts List**

No.	Description	Part No.	Qty.
	30 Inch Out-Feed Table Assembly (includes items 1-10)	OFT30-CNS-000	1
1	Out-Feed Table	OFT30-001	1
2	Out-Feed Table Mounting Bracket	OFT30-002	1
3	M4x1.59x16 Phillips Head Screw	OFT30-003	17
4	M8x30 Hex Head Screw	OFT30-004	6
5	Foot	OFT30-005	2
6	M8x1.25 Hex Nut	OFT30-006	2
7	Support Leg	OFT30-007	2
8	M10x1.5x45 Hex Head Bolt	OFT30-008	4
9	M10x1.5 Nylon Hex Nut	OFT30-009	4
10	Angle Bracket	OFT30-010	4

Copyright SawStop, LLC. All Rights Reserved.  
 SawStop is a registered trademark and T-Glide is a trademark of SawStop, LLC.  
 Updates of these instructions may be available at [www.sawstop.com](http://www.sawstop.com).